

CPVC and PVC Butterfly Valves, Model B



Section A-A

Construction Materials

Part	Material
2. Top Bearing	Glass-Filled PTFE
3. O-Ring Seal (4 required)	FKM or EPDM
4. Disk/Stem	PVC ¹ w/ 316 Stainless Hex Shaft Insert-Molded
5. Body (2 required – mirror image)	3" - CPVC ¹ ; 4" & 6" - PVC
6. Seat/Boot	FKM or EPDM w/ GF-PTFE Upper & Lower Bearing-Bushings Insert-Molded
7. Cap Screws;	3" Valve (6) ea. 1/4"-20 x 7/8" Long Zinc Coated
	4" Valve (6) ea. 5/16"-18 x 1" Long Zinc Coated
	6" Valve (6) ea. 5/16"-18 x 1-1/2" Long & (2) ea. 5/16"-18 x 1" Long Zinc Coated
8. Hex Nuts;	3" Valve (6) ea. 1/4"-20 Zinc Coated
	4" Valve (6) ea. 5/16"-18 Zinc Coated
	6" Valve (8) ea. 5/16"-18 Zinc Coated
9. Lever Handle Assembly	
Handle w/Lever Lock	Malleable Iron
Throttling Plate	Zinc Plated Steel
Position Lock	Zinc Plated Steel

¹ Body, disk/stem, and throttle plate for 3" size are available in CPVC only.

C_v Table

	Degrees Open								
Size	10°	20°	30°	40°	50°	60°	70°	80°	90°
3	4.3	16	35	62	94	135	180	235	290
4	8.6	34	76	137	215	310	420	550	690
6	17.5	67	200	265	410	580	790	1040	1340

Model-B Butterfly Valve Dimensions–Weights

Valve Size	A	B	C	D	E	J	G	H	R	Handle			Approx. ¹ Wt./Lbs.
										M	N	P	
3	4.75	1.26	7.00	3.06	8.50	2.00	3.62	3.38	.37	10.50	1.01	6.19	3.25
4	6.13	1.22	9.00	4.00	10.63	2.22	3.62	3.38	.50	10.50	1.01	6.19	6.00
6	7.50	1.62	11.00	5.97	13.00	2.77	3.76	3.50	.56	13.75	1.01	6.19	12.00

¹ Operator not included in weight.

Features

- Rated at 150 psi with non-shock service at 73°F (6" size 115 psi)
- Mates between ASME B16.5, Class 150; ISO 2084 PN 10, DN 80; and DIN 2532, PN 10, DN 80. Both 4-bolt and 8-bolt patterns are in 3" size.
- PVC overmolded 316 stainless hex shaft not exposed to the liquid
- Top bearing, as well as the upper and lower bushings, are glass-filled PTFE for ease of operation and maximum service life.
- Seat/boot design eliminates need for gaskets between mating flanges.
- Silicone-free lubricant is used to assemble Model B butterfly valves.

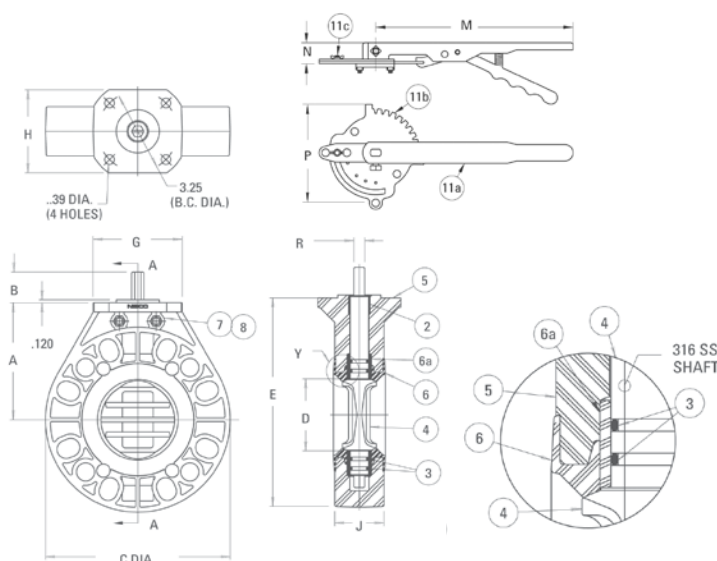

Chemtrol Figure Numbers

Seat Material	Operating Mechanism	3" (CPVC) ² Figure No.	4" (PVC) Figure No.	6" (PVC) Figure No.
EPDM	No Operator	W51BF-E-NO	W45BF-E-NO	W45BF-E-NO
	With Lever ¹ Handle	W51BF-E-LH	W45BF-E-LH	W45BF-E-LH
	With Gear Operator	NA	W45BF-E-GO	W45BF-E-GO
FKM ¹	No Operator	W51BF-V-NO	W45BF-V-NO	W45BF-V-NO
	With Lever ¹ Handle	W51BF-V-LH	W45BF-V-LH	W45BF-V-LH
	With Gear Operator	NA	W45BF-V-GO	W45BF-V-GO

¹ Includes throttle plate and hardware.

² Body and disk/stem for 3" size are available in CPVC only.